



Building Information Models, the Internet of Things and Emerging Technology

Kevin Brown

Master Inventor – Emerging Technology, IBM Research



Background





Building Management System Mobile integration

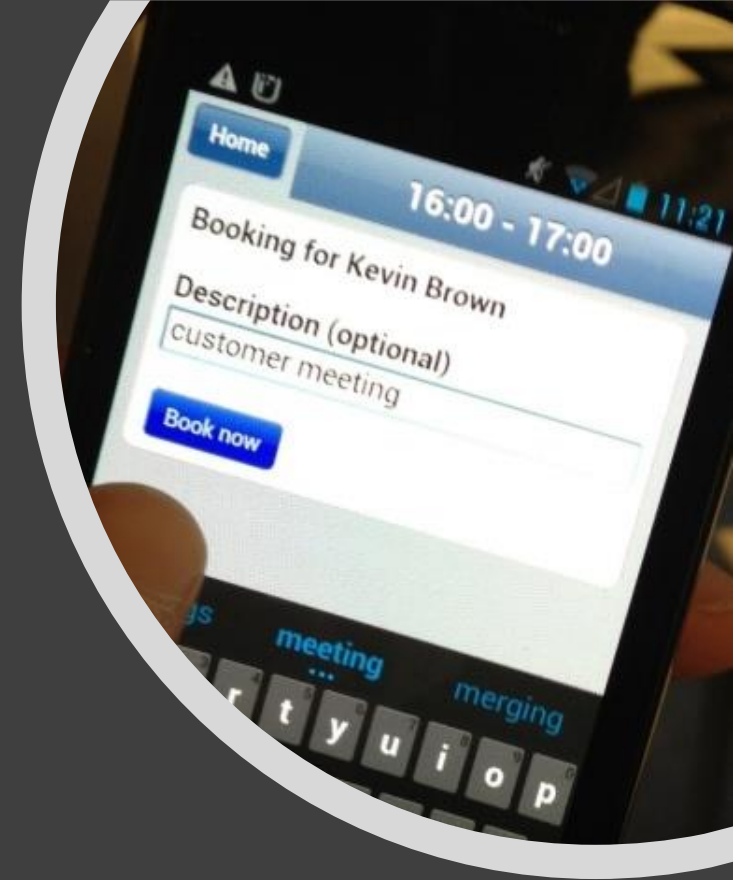

Building Management System Room Reservation integration

Integration with existing Smarter Infrastructure Architecture

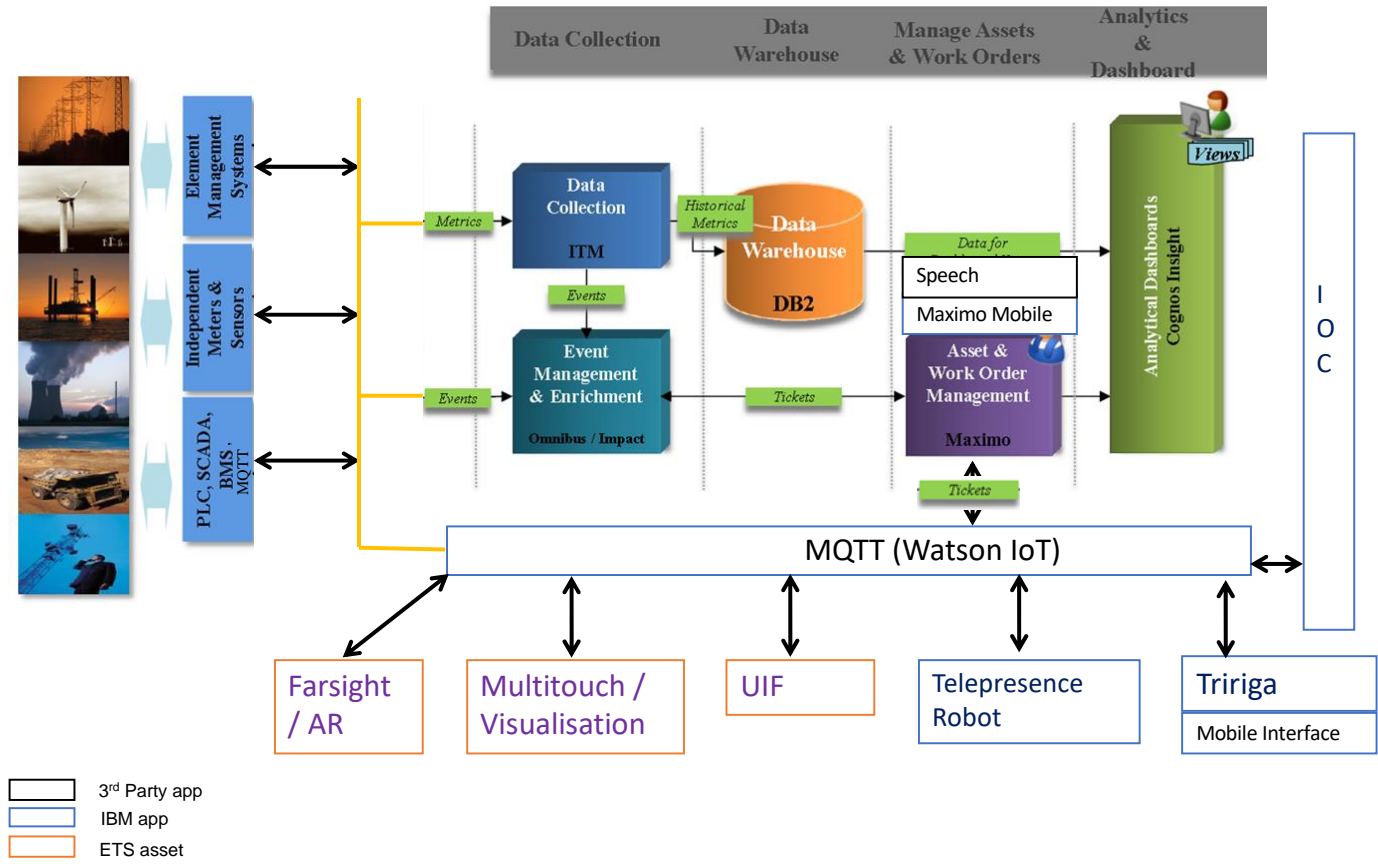

Building information modeling (**BIM**) is a process involving the generation and management of digital representations of physical and functional characteristics of places.

- Requirements
- 3D Models
- Plans
- Inspection & Test Reports
- Operation and Maintenance

BIM

Building Information
Modelling (BIM)
Task Group

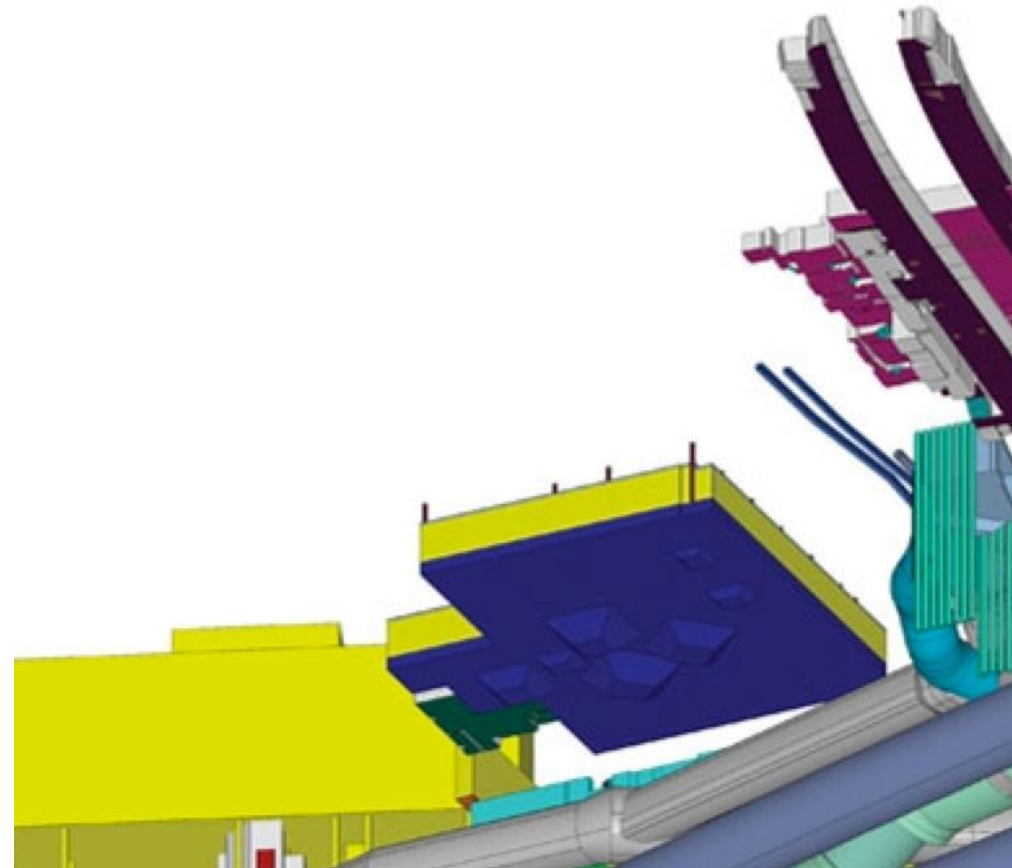

"This Government's four year strategy for BIM implementation will change the dynamics and behaviours of the construction supply chain, unlocking new, more efficient and collaborative ways of working. This whole sector adoption of BIM will put us at the vanguard of a new digital construction era and position the UK to become the world leaders in BIM."

Francis Maude
Minister for the Cabinet Office



- Reduce capital cost, carbon burden by 20%.
- Collaborative 3D BIM on Government projects by 2016.
- Level 3 will enable interconnected digital designs in a built environment and will extend BIM into the operation of assets over their lifetime.

Asset Lifecycle Information Management



JOB REGISTER

Requirements

Design

Build

Commission & Ha...

Operate & Maintain

LINKED APPS

RAID Register

Document Library

FEATURES

Attachments 1

Comments

History

JOB REGISTER

The Job Register app allows Programme jobs to be specified (Requirements) and tracked through to Commission and Maintaion.

<<<< Use the Forms on the left to navigate to the different parts of the Job

Project Information

Project Name

Add pump

Portfolio

Building

Programme Name

Square Office Development

Asset Type

Pump

Current Status

Requirements Created

Requirements

Requirements:

Add a small pump in room B.

Requirements:

Pump water when vat is full blac

Requirements:

Pump display must be visible to a human at all times



Local Projects

- hursleyhouse
- hursleyhousekb
- office_a_20110811

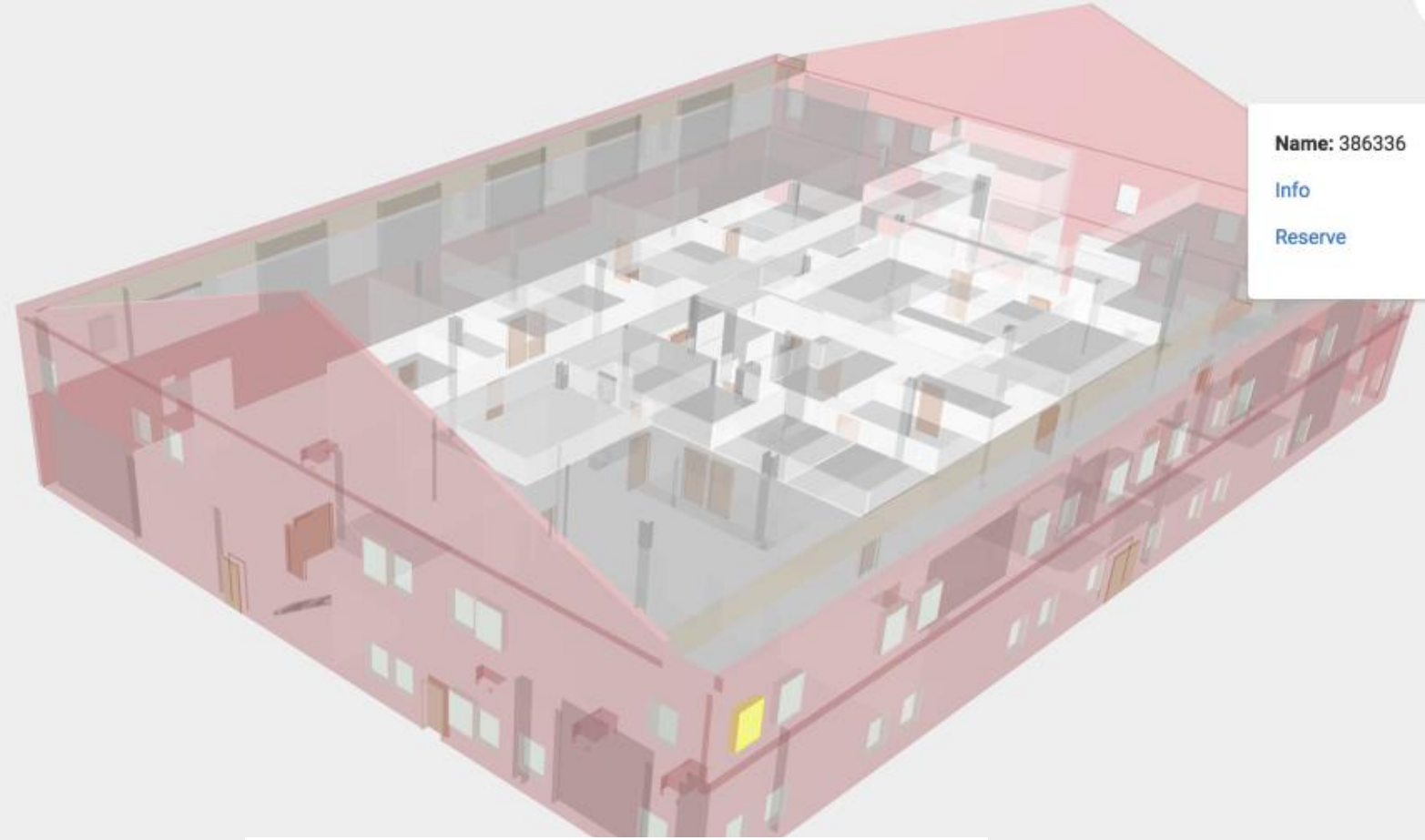

Name: 386336

[Info](#)

[Reserve](#)





← Back to Team Dashboard

Settings Logout



George Clooney
Site Manager

Risk: High



TYPE	TIME	SEVERITY
	14:59:54 02/06/16	● ● ●
	14:59:53 02/06/16	● ● ● ●

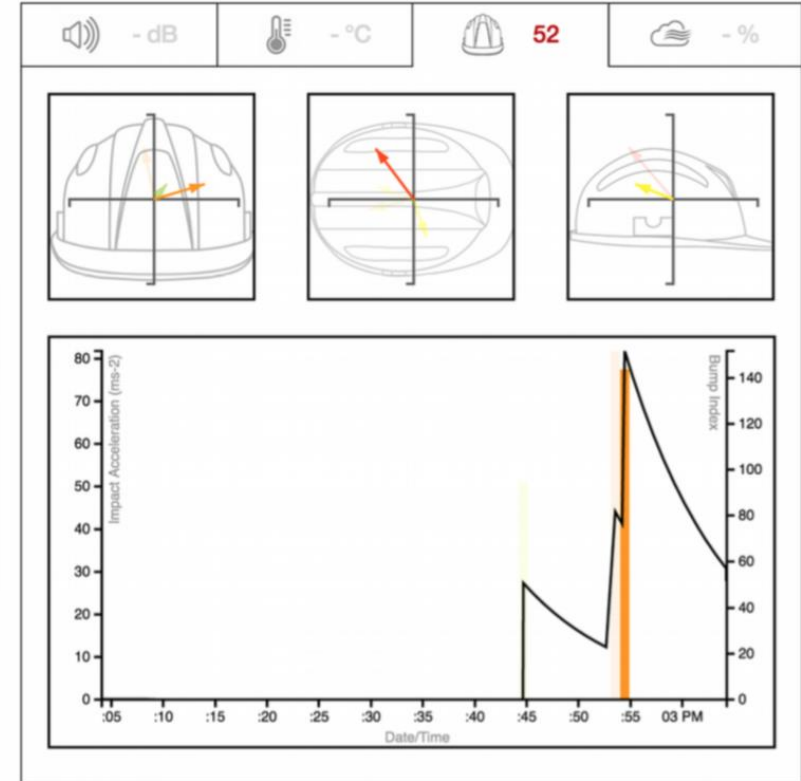

Local Projects

hursleyhouse
hursleyhousekb
office_a_20110811



Details | **Notes** | **Attachments** | **Location** | **Register Asset**

Register

Thank you. This part has been registered with the Asset Management system.
Please print this QR code and place on the asset:



[Print](#)

Name: 386336

[Info](#)

[Reserve](#)

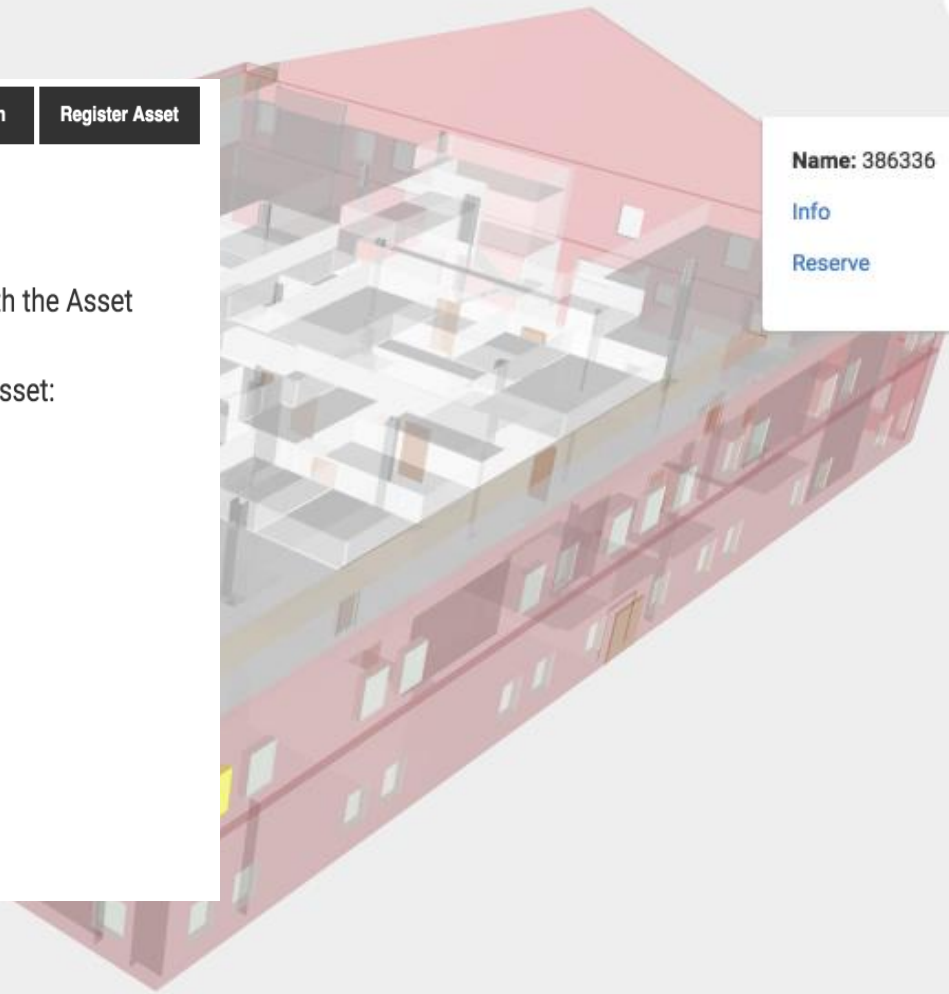







Thank you

Kevin Brown

Master Inventor – Emerging Technology, IBM Research



Wave 1: Marketer's Smarter City: Big Systems

Wave 2: Citizen's Smarter City: Policy makers

Wave 3: Consumer's Smarter City: Free services

Wave 4: Resident's Smarter City: Public/private partnerships